



THIS DRAWING IS COPYRIGHT © CAMBRIA CONSULTING LTD.

DO NOT SCALE FROM THIS DRAWING.

CONTRACTORS MUST CHECK ALL DIMENSIONS ON SITE. ONLY FIGURED DIMENSIONS ARE TO BE WORKED FROM. DISCREPANCIES MUST BE REPORTED IMMEDIATELY TO CAMBRIA CONSULTING LIMITED BEFORE PROCEEDING.

THE CONTRACTOR IS TO REFER TO THE SPECIFICATION, FULL SCHEDULE OF RESIDUAL RISKS IN THE CONTRACT DOCUMENTATION AND ALSO TO INFORMATION FROM OTHER DESIGNERS, IN PARTICULAR THE M&E CONSULTANT REGARDING EXISTING LIVE SERVICES.

THIS SYMBOL IS USED TO HIGHLIGHT INSTANCES OF RISK WITHIN THE CONSTRUCTION PROCESS. ALWAYS CHECK FOR LATER REVISIONS OF THIS DRAWING.

**KEY**

- EXISTING SURFACE WATER DRAINAGE
- EXISTING TO BE MADE REDUNDANT
- SURFACE WATER DRAINAGE PIPE (CARRIER)
- SURFACE WATER DRAINAGE PIPE (PERFORATED)
- SURFACE WATER DRAINAGE CHAMBER
- LINEAR / THRESHOLD CHANNEL DRAIN
- RAINWATER DOWNPIPE
- RODDING EYE
- ACO SUDS OVERFLOW GULLY
- RAINGARDEN
- PERMEABLE BLOCK PAVING
- PERMEABLE ASPHALT PAVING
- GREEN/BLUE ROOF
- ATTENUATION TANK
- PIPED INLET / OUTLET - SUB SURFACE CONNECTION
- INLET DISCHARGING AT SURFACE LEVEL
- DIFFUSER UNIT AT SUB-BASE FORMATION LEVEL
- FOUL DRAINAGE

- NOTES:**
1. PROPOSED DRAINAGE DESIGN IN ACCORDANCE WITH BUILDING REGULATIONS APPROVED DOCUMENT H & SEWERS FOR ADOPTION 7TH EDITION.
  2. DRAINAGE DESIGN SUBJECT TO DETAILED HYDRAULIC MODELLING & CONSULTATION WITH SAB.
  3. DRAINAGE RATES, ATTENUATION STORAGE & EXTENT OF ABOVE GROUND SUDS SUBJECT TO SAB APPROVAL.
  4. ALL DOWNPIPES TO DISCHARGE TO SUDS FEATURES VIA ABOVE GROUND CHANNELS AND BELOW GROUND PIPES.
  5. ALL PIPEWORK Ø150 UNLESS OTHERWISE STATED.
  6. ALL CHAMBER COVERS LOCATED IN VEHICLE TRAFFICKED AREAS TO BE LOAD CLASSIFICATION: D400.
  7. ALL CHAMBER COVERS LOCATED IN NON-VEHICLE TRAFFICKED AREAS TO BE LOAD CLASSIFICATION: B125.
  8. RAINWATER PIPES POSITIONS ARE SHOWN INDICATIVELY AND ARE TO BE CONFIRMED BY THE ARCHITECT.

P02	ISSUED FOR PRE-SAB APPLICATION	GJ	RJ	LKM
				04/03/25
P01	ISSUED FOR RIBA STAGE 3.	JW	RJ	LM
				07/02/25

Rev. Description By Chk App



Project: CAERLEON SCHOOL CB2183

Drawing Title: PROPOSED SURFACE WATER DRAINAGE SHEET 3 OF 3

Drawing No: CB2183 CAM XX XX DR C 0504

Project	Originator	Function	Special	Form	Disc	Number
S4	PRELIMINARY	1:200	@A1:			P02

**CAMBRIA**  
Constructive Thinking

Civil & Structural Engineers  
Cambria House  
16 Plas St. Pl. de Leon  
Penarth Marina  
Cardiff, CF64 1TR

T 029 2009 3333  
E admin@cambria.co.uk  
W www.cambria.co.uk  
@cambriauk  
uk.linkedin.com/in/cambria

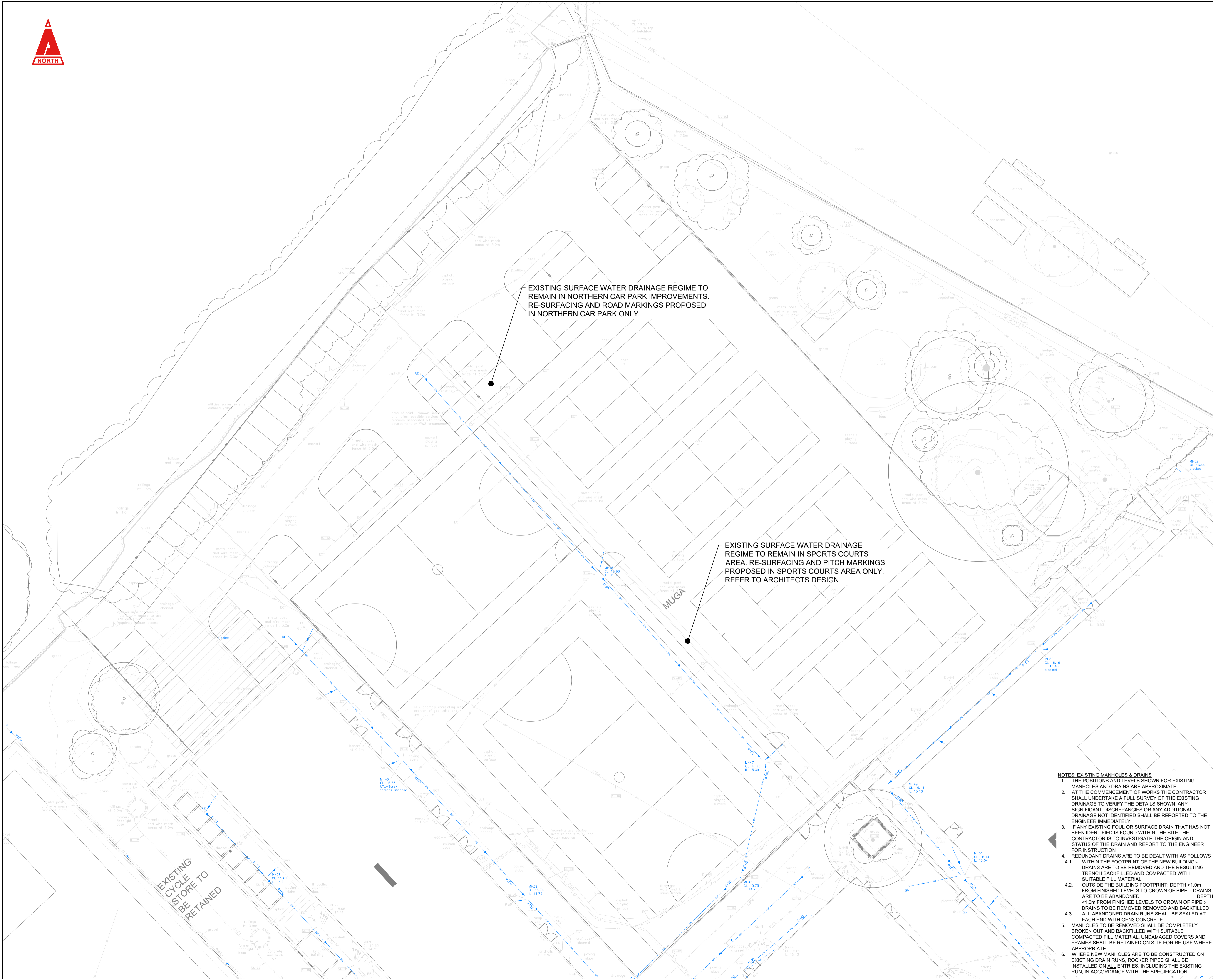

- NOTES: EXISTING MANHOLES & DRAINS**
1. THE POSITIONS AND LEVELS SHOWN FOR EXISTING MANHOLES AND DRAINS ARE APPROXIMATE
  2. AT THE COMMENCEMENT OF WORKS THE CONTRACTOR SHALL UNDERTAKE A FULL SURVEY OF THE EXISTING DRAINAGE TO VERIFY THE DETAILS SHOWN. ANY SIGNIFICANT DISCREPANCIES OR ANY ADDITIONAL DRAINAGE NOT IDENTIFIED SHALL BE REPORTED TO THE ENGINEER IMMEDIATELY
  3. IF ANY EXISTING FOUL OR SURFACE DRAIN THAT HAS NOT BEEN IDENTIFIED IS FOUND WITHIN THE SITE THE CONTRACTOR IS TO INVESTIGATE THE ORIGIN AND STATUS OF THE DRAIN AND REPORT TO THE ENGINEER FOR INSTRUCTION
  4. REDUNDANT DRAINS ARE TO BE DEALT WITH AS FOLLOWS
    - 4.1. WITHIN THE FOOTPRINT OF THE NEW BUILDING - DRAINS ARE TO BE REMOVED AND THE RESULTING TRENCH BACKFILLED AND COMPACTED WITH SUITABLE FILL MATERIAL.
    - 4.2. OUTSIDE THE BUILDING FOOTPRINT: DEPTH > 1.0m FROM FINISHED LEVELS TO CROWN OF PIPE - DRAINS ARE TO BE ABANDONED
    - 4.3. DEPTH < 1.0m FROM FINISHED LEVELS TO CROWN OF PIPE - DRAINS ARE TO BE REMOVED AND BACKFILLED WITH SUITABLE FILL MATERIAL. ALL ABANDONED DRAIN RUNS SHALL BE SEALED AT EACH END WITH GENS CONCRETE
    - 4.4. MANHOLES TO BE REMOVED SHALL BE COMPLETELY BROKEN OUT AND BACKFILLED WITH SUITABLE COMPACTED FILL MATERIAL. UNDAMAGED COVERS AND FRAMES SHALL BE RETAINED ON SITE FOR RE-USE WHERE APPROPRIATE
    - 4.5. WHERE NEW MANHOLES ARE TO BE CONSTRUCTED ON EXISTING DRAIN RUNS, ROCKER PIPES SHALL BE INSTALLED ON ALL ENTRIES, INCLUDING THE EXISTING RUN, IN ACCORDANCE WITH THE SPECIFICATION.