

NOTES
 Check all dimensions on site. Do not scale from this drawing.
 Report any discrepancies and omissions to HLM Architects.
 This Drawing is Copyright ©

DESIGN/SKETCH DESIGN
 Unless stated otherwise, the designs shown are subject to detailed site survey, investigations, and legal definitions, the CDM Regulations, and the comments and / or approval of the various relevant Local Authority Officers, Statutory Undertakers, Fire Officers, Engineers and the like. They are copyright, project specific and confidential and no part is to be used or copied in any way without the express prior consent of HLM Architects.

PHOTOCOPIED/SCANNED INFORMATION
 NB This drawing is based on photocopied / scanned information liable to distortion in scale.

AREA CALCULATIONS
 NB The areas shown are approximate only and have been measured off preliminary drawings as the likely areas at the current stage of design using the stated option from the Code of Measuring Practice, 4th edition, RICS/NSA. These may be affected by future design development and construction tolerances, or the result of surveys for existing buildings. Take account of these factors before planning any financial or property development purpose or strategy and seek confirmation of latest area before decision making.

3RD-PARTY INFORMATION
 NB This drawing includes information provided by independent surveyors and/or consultants, to whom all queries shall be made. HLM Architects can accept no liability for its content or accuracy.

DEPARTMENT

◻	CIRCULATION
◻	GENERAL TEACHING
◻	HALLS
◻	KITCHEN
◻	LEARNING RESOURCE
◻	PLAY
◻	SPECIALIST TEACHING
◻	STAFF
◻	STORES
◻	WC SUITES

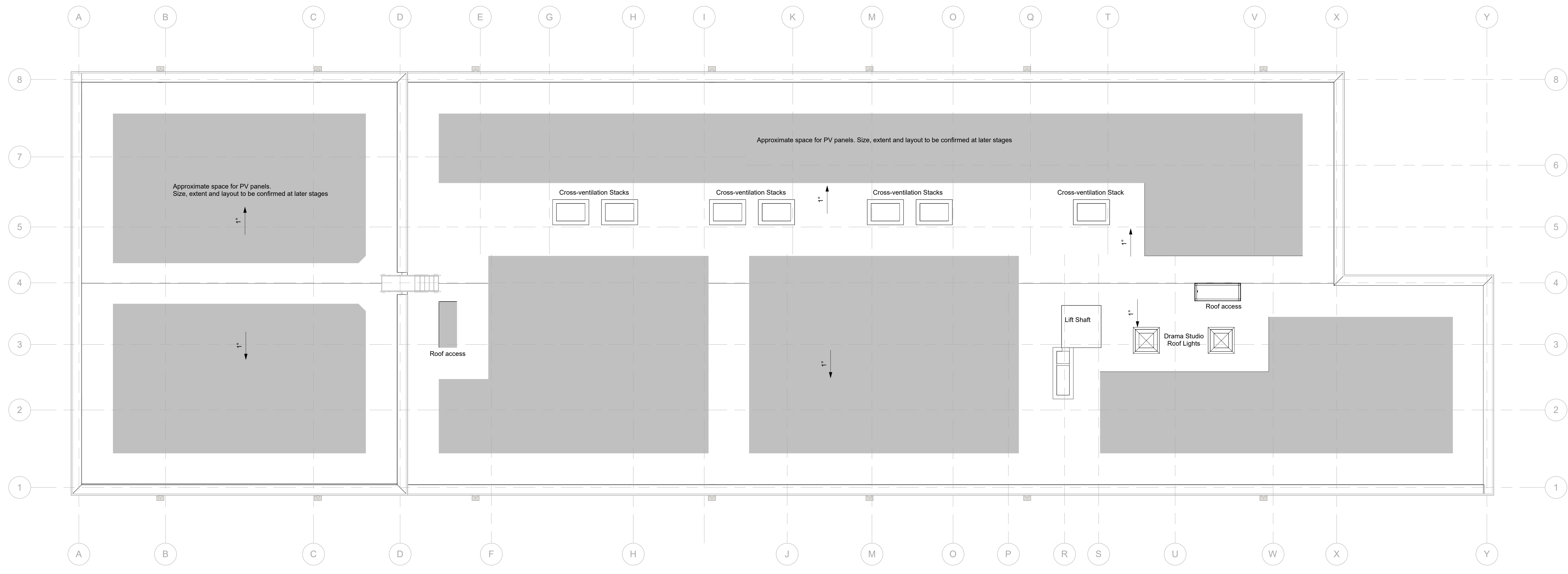
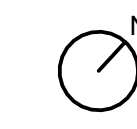

Refer to 6868-MCP-V1-RF-DR-E-9002-A0H for official PV Layout

PRG	PAC	03/03/2025	JM	AMB
REV	DESCRIPTION	DATE	BY	CHK

Revisions: Suitability

Caerleon Comprehensive School - New Building

Client:
NEWPORT CITY COUNCIL / NEWPORT NORSE

Title:
New Block - Roof Plan

Drawing No.	Revision
CCS-HLM-NN-R1-DR-A-00131	P02

Scale	Drawn
As indicated @A0	HLM
Date	Checked
04/11/2024	HLM

HLM Architects
 © HLM Architects
 Suits 304, The Creative Quarter
 Morgan Arcade, The Hayes
 Cardiff, CF10 1AF
 www.hlmarchitects.com
 T. +44 (0) 29 2039 6070
 cardiff@hlmarchitects.com

